

Machining direction

Pivot point

Axis ζ

Center of holder

Swiveling center

Center of profile

Center of cutting insert

Please check and confirm the rotation direction!

Rotation direction

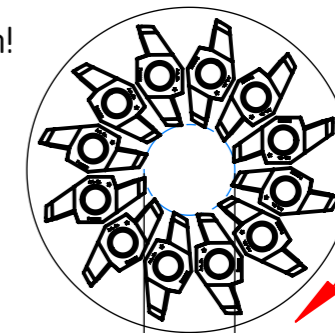

DF = \varnothing 12
Flight circle

Bar machine direction

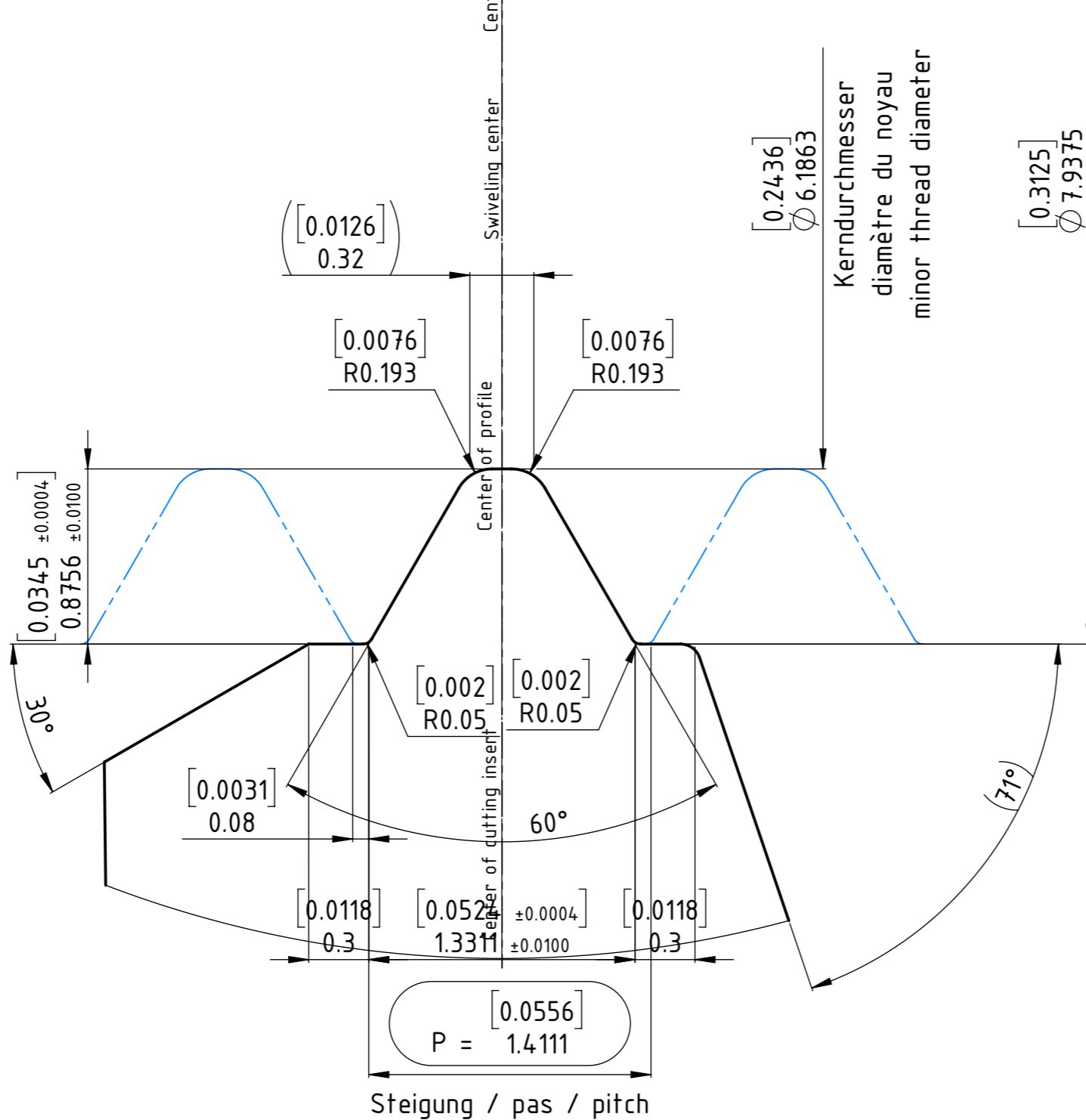
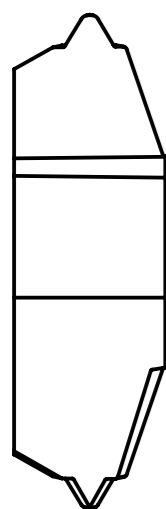
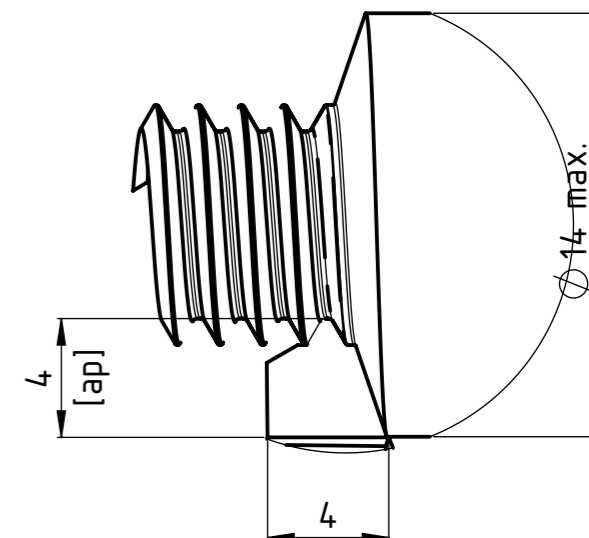

Steigung / pas / pitch

Number of starts/leads:

1

Leadangle:

3.64°

Original drawing:

ASME B1.1-2003 / 5/16-18UNC

Beschreibung
multidec®-WHIRLING Wendeplatte

Artikel Bezeichnung
MWI12 164 5/16-18UNC VP

Zeichnungsnummer
MWI-3249

UTILIS
Tooling for High Technology

A3

Index
-