

Please check and confirm the rotation direction!

Rotation direction

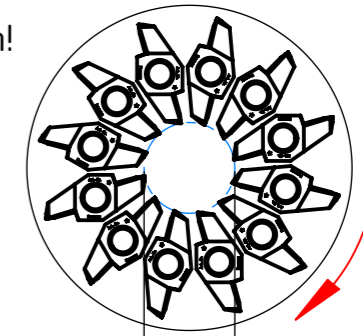
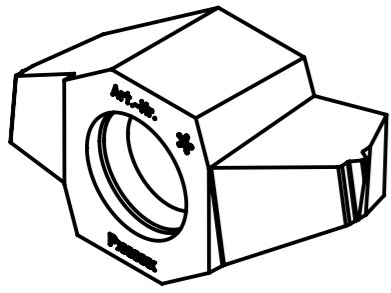

DF = \varnothing 12
Flight circle

Machining direction

Pivot point

Axis φ

Swiveling center
Center of holder

$[0.0841 \begin{smallmatrix} 0 \\ -0.0078 \end{smallmatrix}]$

\varnothing 2.1361 $\begin{smallmatrix} 0 \\ -0.1981 \end{smallmatrix}$

Kerndurchmesser
diamètre du noyau
minor thread diameter

$[0.1112 \begin{smallmatrix} 0 \\ -0.0051 \end{smallmatrix}]$

\varnothing 2.8245 $\begin{smallmatrix} 0 \\ -0.1295 \end{smallmatrix}$

Aussendurchmesser
diamètre du sommet de filet
major thread diameter

$[0.0142 \pm 0.0004]$
0.3613 ± 0.0100

$[0.0027]$
R0.0687

$[0.0027]$
R0.0687

Center of profile

R0.05

R0.05

60°

Center of cutting insert

$[0.0039]$
0.099

$[0.0118]$
0.3

$[0.0211 \pm 0.0004]$
0.536 ± 0.0100

$[0.0118]$
0.3

$[0.025]$
P = 0.635

Steigung / pas / pitch

Bar machine direction

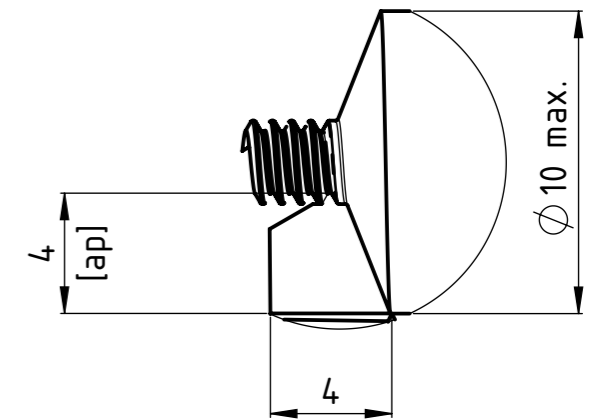

Number of starts/leads:

1

Leadangle:

4.82°

Original drawing:

ASME B1.1-2019 / 04-40UNC-2A

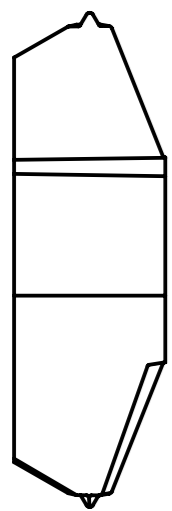

Beschreibung

multidec®-WHIRLING Wendeplatte

Artikel Bezeichnung

MWI12 164 04-40UNC-2A VP

Zeichnungsnummer

MWI-3456

UTILIS
Tooling for High Technology

A3

Index
-