

1 2 3 4 5 6

A A

B B

C C

D D

A4-Kunde V7

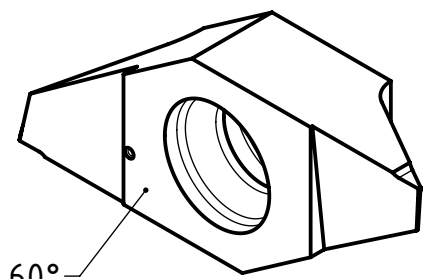
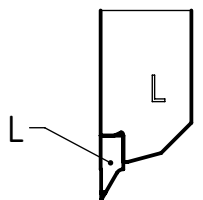
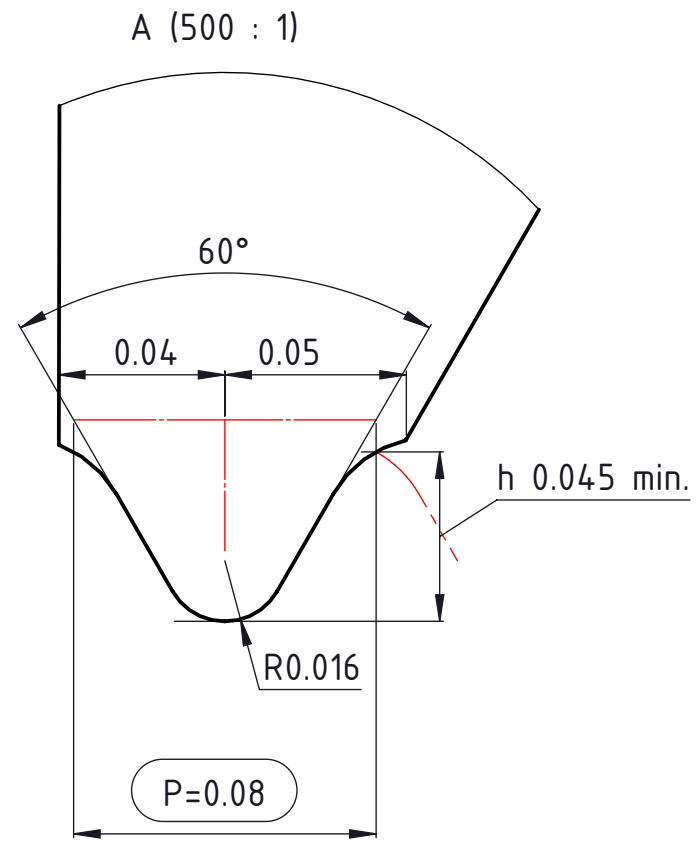
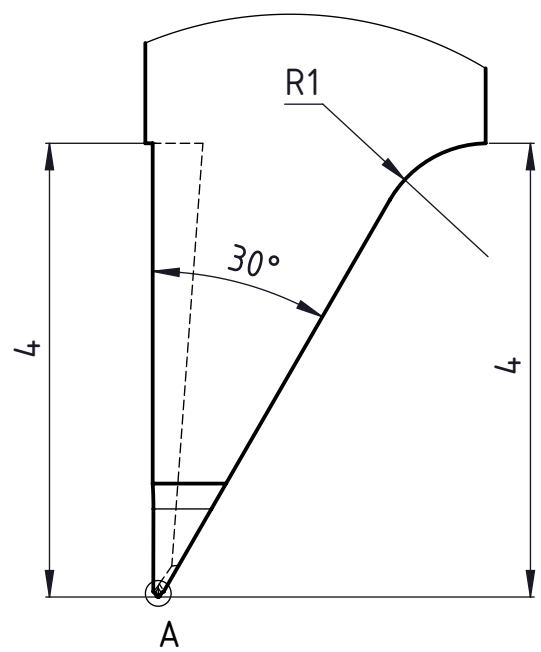
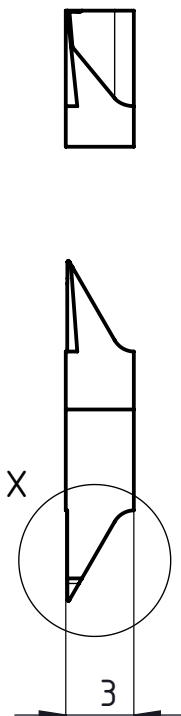
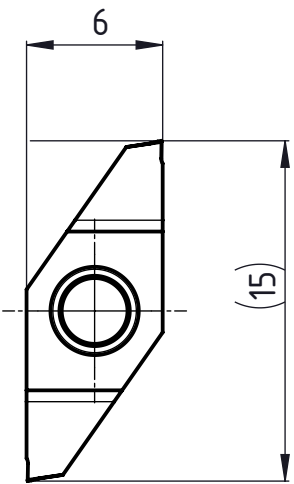

Linke Ausführung
Execution gauche
Left execution

Norm NIHS 06-02 SN 280 602 S0.30

Freigegeben von am T.Weilenmann am 16.12.2020
erstellt von am C.Fabozzi am 31.03.2020

Beschreibung multidec-CUT Wendepatte
Artikel Bezeichnung 1606-0.08-60 VP L

UTILIS <small>Tooling for High Technology</small>
Zeichnungsnummer CUT-938-01-04

Index B